

9 Displacements	(4.9 - 22.2 in ³ /rev)	
9 Schluckvolumen	81 ... 364 cm ³ /rev	
9 Cylindrée		
9 Despazamientos		
	Cont.	Int.
Maximum Pressure	(to 3000 psi)	(to 4000 psi)
Eingangsdruck	... 210 bar	... 281 bar
Pression entrée		
Presion Maxima		
Maximum Oil Flow	(to 25 gpm)	
Schluckstrom	.. .95 lpm	
Débit d'huile		
Caudal Maximo de Aceite		
Maximum Speed	(749 rpm)	
Drehzahl	749 rpm	
Vitesse de rotation		
Velocidad Maxima		
	Cont.	Int.
Maximum Torque	(4502 lb in)	(7029 lb in)
MaxDrehmoment	509 Nm	794 Nm
Couple		
Torque Maximo		
Maximum Side Load at Key	(to 3597 lb)	
Seitenlast	... 16000 N	
Charges latérales		
Carga Maxima Lateral		

The Clutch Motor consists of a TF Series motor separated from the output shaft by a face spline coupling. The coupling is held apart by springs, disconnecting the motor from the output shaft, allowing the output shaft to freewheel. When hydraulic pressure is applied to either motor port, the springs separating the coupling are overcome and the motor is coupled to the output shaft.

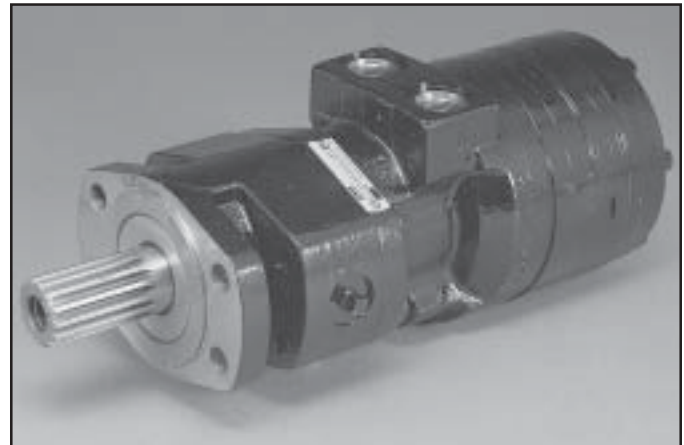

Notes:

- 1) Consult factory if clutch is to be engaged while output shaft is rotating.
- 2) Clutch may not disengage if there is residual torque on output shaft when pressure is lost at motor ports.
- 3) Minimum pressure to engage clutch - 125 PSI.
- 4) To assure clutch disengagement, pressure at motor ports must be below 70 PSI.
- 5) Shaft will freewheel when pressure is lost at motor ports whether by design or inadvertently. The possibility of unplanned freewheeling should be considered in the design of the system.
- 6) Maximum torque capability is 7029 in lbs.

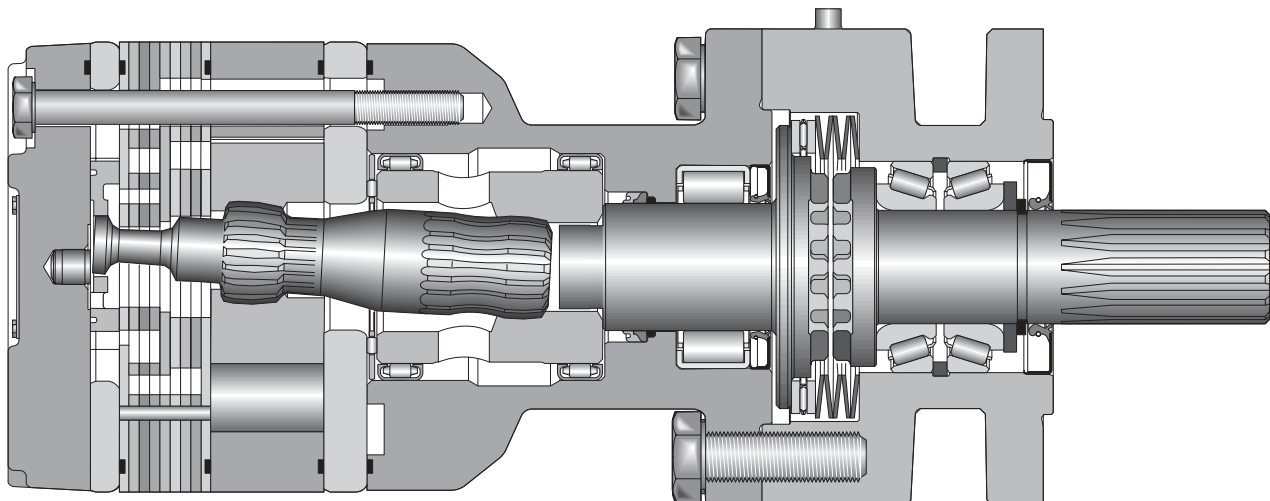

Code: G 

4 Bolt Magneto, Clutch

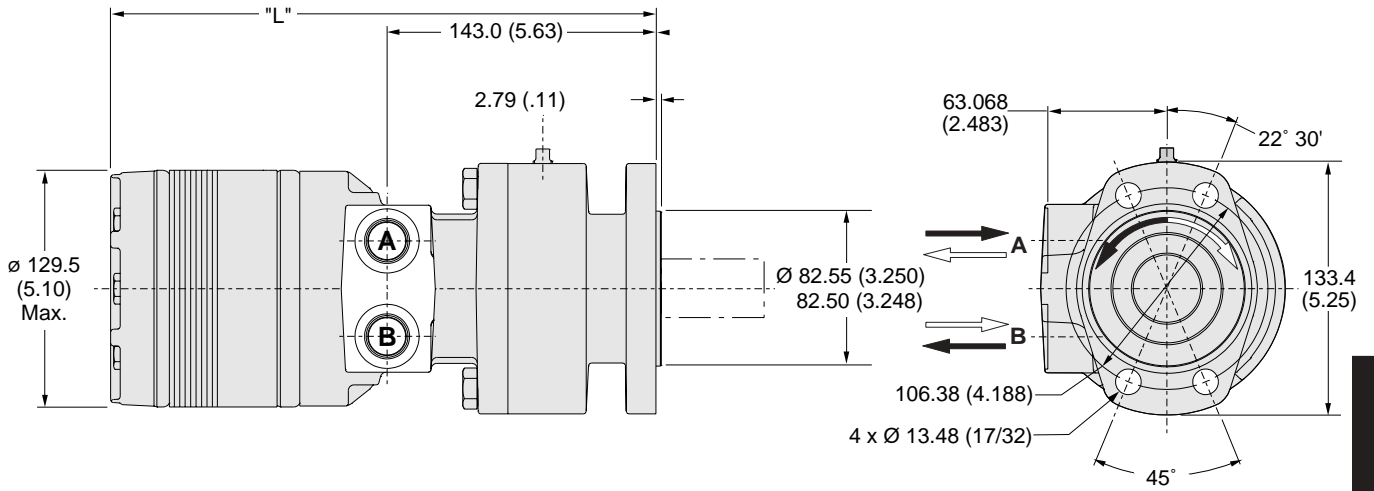

Code G	disp.	0080	0100	0130	0140	0170	0195	0240	0280	0365
Weight/Gewicht	kg	17.9	17.9	18.1	18.2	18.5	18.8	19.2	19.5	20.3
Poids/Peso	(lb)	(39.3)	(39.4)	(39.9)	(40.1)	(40.7)	(41.3)	(42.3)	(42.9)	(44.6)
Length	"L" mm	270	270	273	275	278	281	286	290	300
	"L" (in)	(10.61)	(10.61)	(10.73)	(10.80)	(10.92)	(11.05)	(11.23)	(11.42)	(11.80)

Code: S 

7/8-14 SAE O-Ring

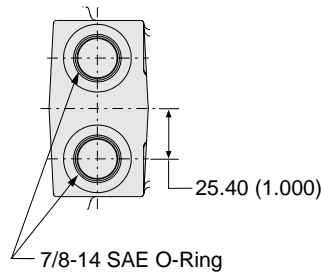

English equivalents for metric specifications are shown in ().

Global TF Clutch.p65, pfm, fm

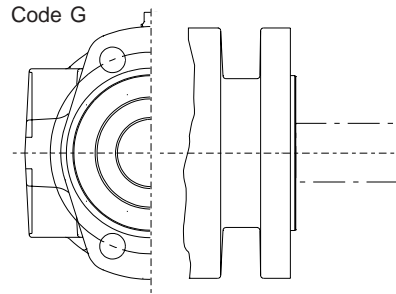

Code: 03 

1 1/4" Keyed

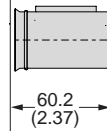

Code: 05 

1 1/4" 14 Tooth
Spline

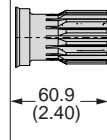

Code: 03 

1 1/4" Keyed

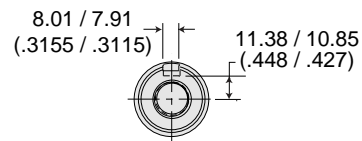
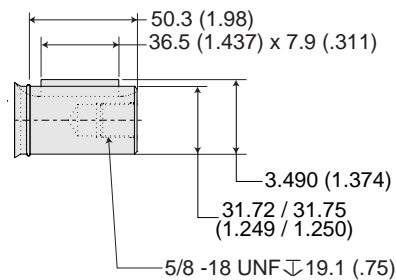



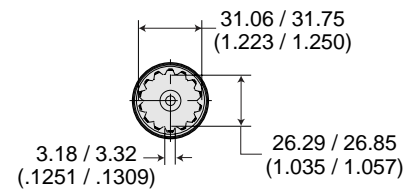
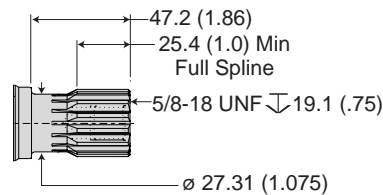

Code: 05 

1 1/4" 14 Tooth
Spline

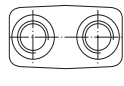
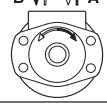
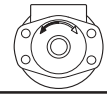
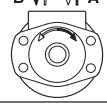
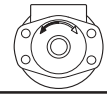
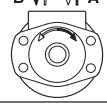
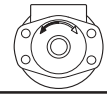

English equivalents for metric specifications are shown in ().

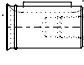
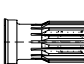
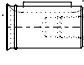
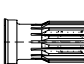
Global TF Clutch.p65, pfm, fm

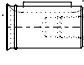
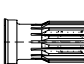
TF	XXXX	G	S	XX	X	XXXX																																	
Series	Displacement Schluckvolumen Cylindrée Desplazamiento	Mounting Gehäuse Carter Montaje	Ports Anschluß Plan de raccordement Lumbreras	Shaft Welle Arbre Eje	Rotation Drehrichtung Direction de rotation Rotacion	Options Opciones																																	
	<table border="1"> <thead> <tr> <th>Code</th> <th>cm³/U / cm³/rev cm³/tr / cm³/giro</th> </tr> </thead> <tbody> <tr><td>0080</td><td>4.9 / 81</td></tr> <tr><td>0100</td><td>6.1 / 100</td></tr> <tr><td>0130</td><td>7.8 / 128</td></tr> <tr><td>0140</td><td>8.6 / 141</td></tr> <tr><td>0170</td><td>10.3 / 169</td></tr> <tr><td>0195</td><td>12.0 / 195</td></tr> <tr><td>0240</td><td>14.5 / 237</td></tr> <tr><td>0280</td><td>17.1 / 280</td></tr> <tr><td>0365</td><td>22.2 / 364</td></tr> </tbody> </table>	Code	cm ³ /U / cm ³ /rev cm ³ /tr / cm ³ /giro	0080	4.9 / 81	0100	6.1 / 100	0130	7.8 / 128	0140	8.6 / 141	0170	10.3 / 169	0195	12.0 / 195	0240	14.5 / 237	0280	17.1 / 280	0365	22.2 / 364		<table border="1"> <thead> <tr> <th>Code</th> <th>Avail.</th> </tr> </thead> <tbody> <tr> <td>S</td> <td>US</td> </tr> </tbody> </table> 	Code	Avail.	S	US		<table border="1"> <thead> <tr> <th>Code</th> <th>Rotation</th> <th>Avail.</th> </tr> </thead> <tbody> <tr> <td>0</td> <td>Standard </td> <td>EU US</td> </tr> <tr> <td>1</td> <td>Reverse Timed Manifold </td> <td>EU US</td> </tr> </tbody> </table>	Code	Rotation	Avail.	0	Standard 	EU US	1	Reverse Timed Manifold 	EU US	
Code	cm ³ /U / cm ³ /rev cm ³ /tr / cm ³ /giro																																						
0080	4.9 / 81																																						
0100	6.1 / 100																																						
0130	7.8 / 128																																						
0140	8.6 / 141																																						
0170	10.3 / 169																																						
0195	12.0 / 195																																						
0240	14.5 / 237																																						
0280	17.1 / 280																																						
0365	22.2 / 364																																						
Code	Avail.																																						
S	US																																						
Code	Rotation	Avail.																																					
0	Standard 	EU US																																					
1	Reverse Timed Manifold 	EU US																																					
		<table border="1"> <thead> <tr> <th>Code</th> <th>Mounting</th> <th>Avail.</th> </tr> </thead> <tbody> <tr> <td>G</td> <td>Magneto </td> <td>US</td> </tr> </tbody> </table>	Code	Mounting	Avail.	G	Magneto 	US		<table border="1"> <thead> <tr> <th>Code</th> <th>Shaft</th> <th>Avail.</th> </tr> </thead> <tbody> <tr> <td>03</td> <td>1 1/4" Keyed </td> <td>US</td> </tr> <tr> <td>05</td> <td>1 1/4" 14 Tooth Spline </td> <td>US</td> </tr> </tbody> </table>	Code	Shaft	Avail.	03	1 1/4" Keyed 	US	05	1 1/4" 14 Tooth Spline 	US																				
Code	Mounting	Avail.																																					
G	Magneto 	US																																					
Code	Shaft	Avail.																																					
03	1 1/4" Keyed 	US																																					
05	1 1/4" 14 Tooth Spline 	US																																					
						<table border="1"> <thead> <tr> <th>Code</th> <th>Avail.</th> </tr> </thead> <tbody> <tr> <td>AAAB</td> <td>No Paint No lackiert EU US</td> </tr> <tr> <td>AAAA</td> <td>Black Paint Schwarz lackiert EU US</td> </tr> </tbody> </table>	Code	Avail.	AAAB	No Paint No lackiert EU US	AAAA	Black Paint Schwarz lackiert EU US																											
Code	Avail.																																						
AAAB	No Paint No lackiert EU US																																						
AAAA	Black Paint Schwarz lackiert EU US																																						

See Page 219 for Additional Options

US US Standard
 EU Euro Standard